

Mid-West University  
**Examinations Management Office**  
End Semester Examinations 2081

Bachelor level/ B.E. Computer/ 1<sup>st</sup> Semester  
Time: 4 hours  
Subject: Engineering Drawing I (ME411/ME501)

Full Marks: 50  
Pass Marks: 25

- Attempt all the questions
- Figures in the margin indicate full marks.
- Assume suitable values, with a stipulation, if necessary.
- Candidates are required to answer the questions in their own words as far as possible.

1. Draw a regular pentagon on a circumscribing circle of 80 mm diameter. [6]
2. Draw a locus of a point on the circumference of a circle of radius 40 mm for one complete rotation when it rolls on a horizontal surface. [10]
3. Translate the given pictorial views into three-view orthographic drawings with proper dimension. [15]

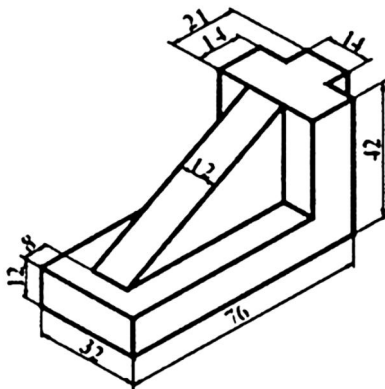

4. Make a complete orthographic drawing of a geometrical solid cut by a plane. Find the true shape of the section. Construct the development of the surface of the solid. [12]

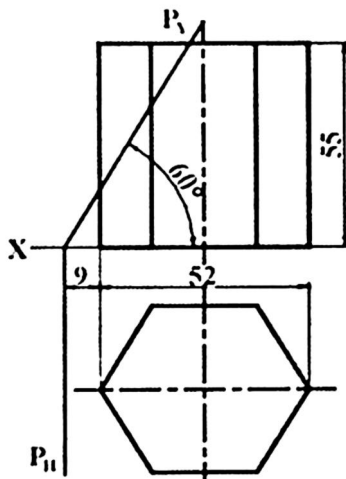

5. Calculate the maximum and minimum limits for both the shaft and hole in the following using the tables for the tolerance and name the type of fit obtained. [7]  
45H8/d7.

**The End**