

Mid-West University
Examinations Management Office
 End Semester Examinations 2081

Bachelor level/ B.E. Civil/ 1st Semester
 Time: 4 hours

Full Marks: 50
 Pass Marks: 25

Subject: Engineering Drawing I (ME411/ME101)

- Attempt all the questions
- Figures in the margin indicate full marks.
- Assume suitable values, with a stipulation, if necessary.
- Candidates are required to answer the questions in their own words as far as possible.

1. Draw a line whose length is 100 mm and divide it in the ratio of 1:2:3. [5]
2. Draw one turn of a helix of pitch 90 mm on a cylinder of diameter 60 mm. [8]
3. Translate the given pictorial views into three-view orthographic drawings with proper dimension. [15]
 Note the given solid is symmetrical in nature.

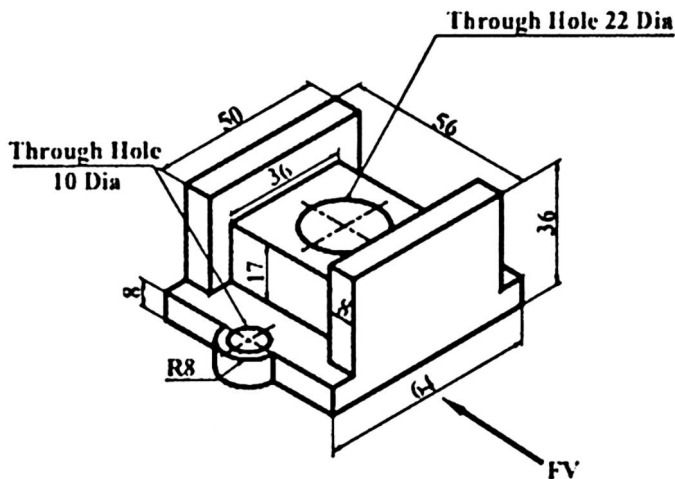

4. A regular pentagon ABCDE, of 30 mm side, has its side BC in HP. Its plane is perpendicular to the HP and inclined at 60° to the VP. Draw the projections of the pentagon when its corner nearest to VP is 15 mm from it. [12]
5. Draw the given views of assigned form and complete the intersection. [10]

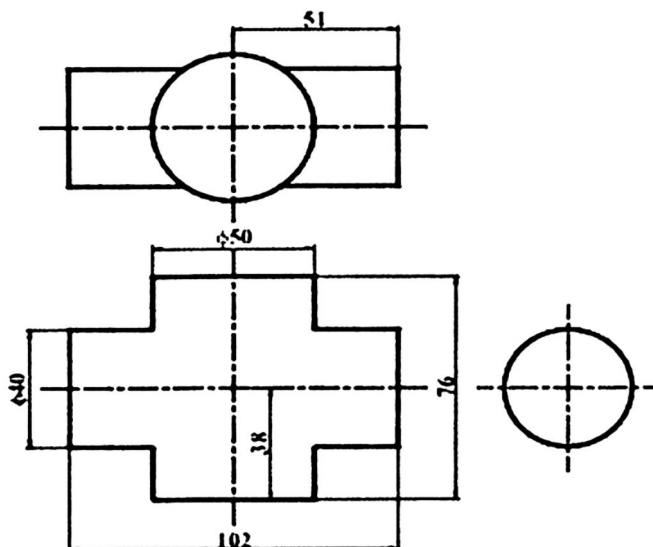

The End